

Project:

# Radiant Lines LED Double Sconce Spec Sheet

SKU: 3812.01

Exquisitely refined, an LED edge-lit glass panel produces bidirectional luminance with transparency, from precisely controlled parallel Radiant Lines in a tight surface pattern. Available in two configurations: with dual glass panels and a single glass panel with a wall-washing downlight recessed within the rectilinear form. Also available as an [LED Sconce w/ Downlight](#).

Learn more: <https://sonnemanlight.com/radiant-lines-led-double-sconce>

Type #:

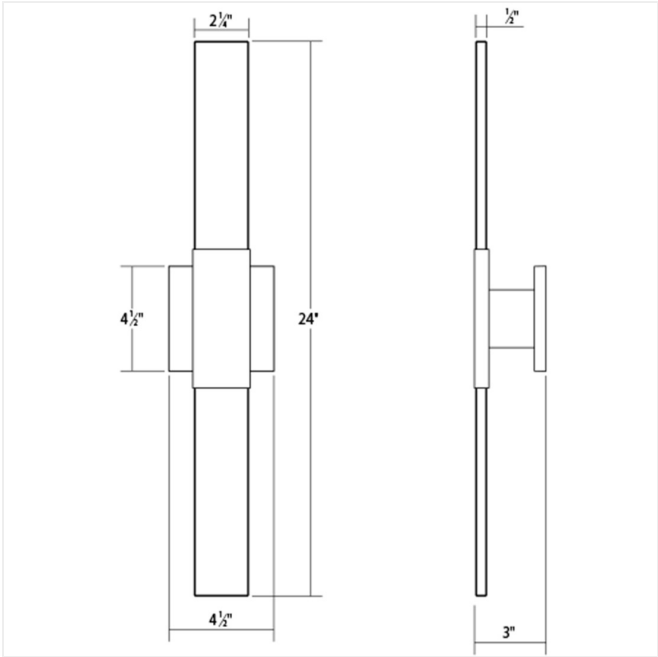

## Dimensions

Height:	24"
Width:	2.5"
Extends:	3"
Minimum Extension:	3"
Maximum Extension:	3"
Canopy/Backplate/Base Width:	4.5"
Canopy/Backplate/Base Depth:	0.5"
Canopy/Backplate/Base Height:	4.5"

## Electrical Specs

Bulb(s) Included?:	Yes
Bulb 1 Type:	Integral LED
Bulb Quantity:	2
Input Voltage:	120VAC
Wattage:	17
Initial Lumens:	1590
Delivered Lumens:	1060
Kelvin:	3000K
CRI:	90
Power Supply Type:	Driver
Power Supply Quantity:	1
Power Supply Location:	Outlet Box
Dimming Type:	TRIAC/ELV
Bulb Max Wattage:	17

## Installation

Installation:	Licensed electrician required
Installation Orientation:	Vertical

## Shipping

Carton 1 L x W x H:	16" X 8" X 8"
Carton 1 Gross Weight:	5 LBS

## Shade

Shade Material:	Glass Light Guide
-----------------	-------------------

## General Listings

Features:	While Supplies Last
Certification:	C-ETL-US
Color/Finish:	Polished Chrome (.01)
Dark Sky Friendly:	N

## Available Finishes

Available Finishes:	Polished Chrome (.01)
---------------------	-----------------------

## Available Color Temperatures

Available Color Temperatures:	3000k
-------------------------------	-------