

Project:

Quadratto Swing Wall Lamp Spec Sheet

SKU: 6089.13

Contrasting its heavy vertical stem with the thin profile of the horizontal arm creates a bold structure of visual tension. It supports a wide drum shade that swivels outward when light is needed over a reading area, or swings back into compact containment for a wash of ambient light.

Learn more: <https://sonnemanlight.com/quadratto-swing-wall-lamp>

Type #:

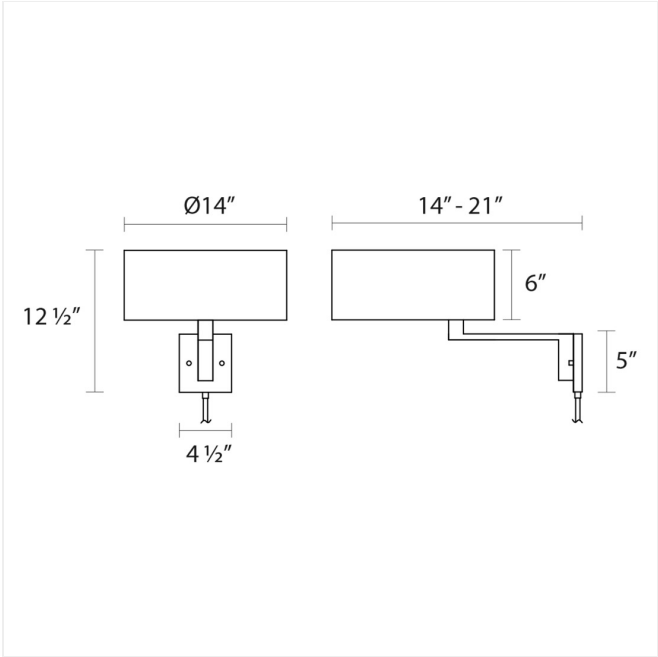

Dimensions

Height:	12.5"
Width:	14"
Minimum Extension:	21"
Maximum Extension:	14"
Canopy/Backplate/Base Depth:	4.5
Canopy/Backplate/Base Height:	5

Electrical Specs

Bulb 1 Type:	Medium Base
Bulb Quantity:	2
Input Voltage:	120VAC
Wattage:	60
Bulb Max Wattage:	60

Installation

Installation:	No electrician required
Installation Orientation:	Vertical

Shipping

Carton 1 L x W x H:	17" X 15" X 10"
Carton 1 Gross Weight:	9 LBS
Carton 2 L x W x H:	16" X 16" X 8"
Carton 2 Gross Weight:	2 LBS

Shade

Shade Material:	Linen
-----------------	-------

General Listings

Features:	While Supplies Last
Certification:	C-UL-US
Color/Finish:	Satin Nickel (.13)
Dark Sky Friendly:	N

Available Finishes

Available Finishes:	Satin Nickel (.13)
---------------------	--------------------

Available Color Temperatures

Available Color Temperatures:	Bulb Not Included
-------------------------------	-------------------