

Project:

ALC LED Sconce Spec Sheet

SKU: 3052.13-FN25

A classic modern architectural lighting form, Architectural Lighting Cylinders are available in a [surface mount configuration](#) as well as a sconce and [pendant](#) in a variety of sizes and finishes, with multiple beam spread options and a number of glass and metal trims.

Learn more: <https://sonnemanlight.com/alc-led-sconce>

Type #:

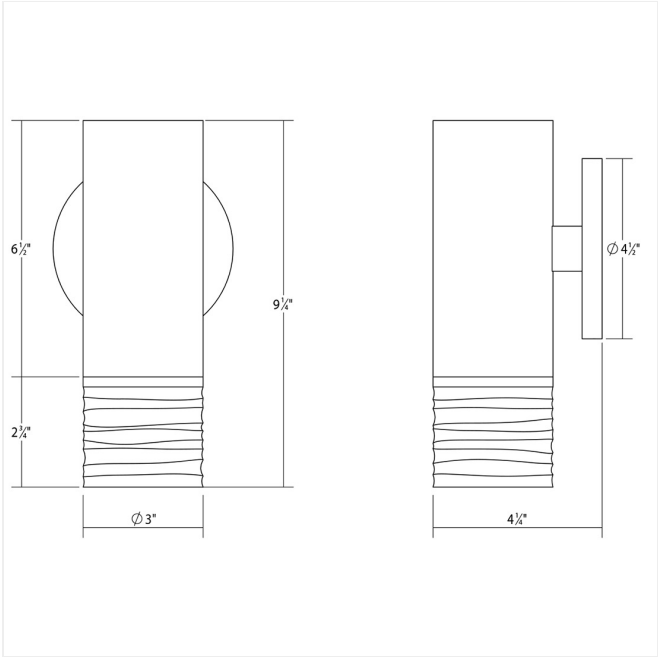

Dimensions

Height:	9.25"
Extends:	4.25"
Minimum Extension:	4.25"
Maximum Extension:	4.25"
Diameter:	3"
Canopy/Backplate/Base:	4.5"
Shape:	Etched Ribbon Glass Trim
Size:	3" One-Sided
Canopy/Backplate/Base Depth:	0.5"

Electrical Specs

Bulb(s) Included?:	Yes
Bulb 1 Type:	Integral LED
Bulb Quantity:	1
Input Voltage:	120VAC
Wattage:	20
Initial Lumens:	2110
Delivered Lumens:	1400
Kelvin:	3000K
CRI:	90
Power Supply Type:	Driver
Power Supply Quantity:	1
Power Supply Location:	Outlet Box
Dimming Type:	TRIAC/ELV
Bulb Max Wattage:	20

Installation

Installation:	Licensed electrician required
Installation Orientation:	Any Orientation

Shade

Lens Type:	25 Narrow Flood Lens
Shade Material:	Etched Ribbon Glass

General Listings

Features:	At NYDC, Damp Rated
Certification:	C-ETL-US
Color/Finish:	Satin Nickel (.13)

Available Finishes

Available Finishes:	Satin Nickel w/Bezel Trim, Satin Nickel w/Etched Glass Trim, Satin Nickel w/Etched Ribbon Glass Trim, Satin Nickel w/Snoot Trim
---------------------	---

Available Color Temperatures

Available Color Temperatures:	3000k
-------------------------------	-------

Options In This Family

SKU	Size	Wattage	CRI	Delivered Lumens
3050.XX-BN25	2" One-Sided	10	90	800
3050.XX-SN25	2" One-Sided	10	90	800
3050.XX-BK35	2" One-Sided			
3050.XX-GK55	2" One-Sided	10	90	800
3051.XX-GN25-GN25	2" Two-Sided	20	90	1600
3053.XX-GN25-GN25	3" Two-Sided	40	90	2800